

I-96/Grand River Avenue Interchange Update

Brighton

Jan. 10, 2025



Primary Detour 1

- ▶ During westbound loop ramp closure:
 - ▶ Westbound on ramp traffic taken to Spencer Road along eastbound I-96.

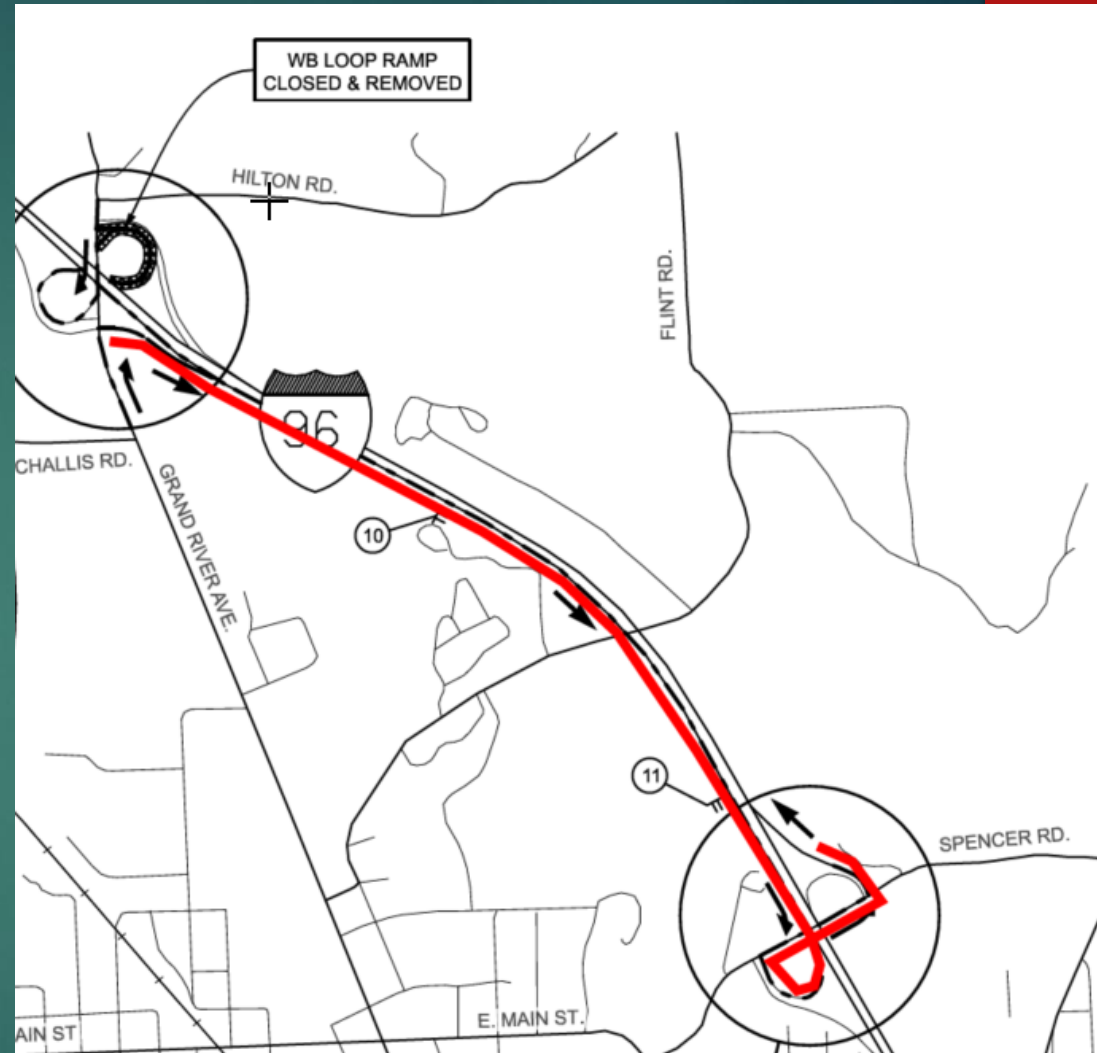
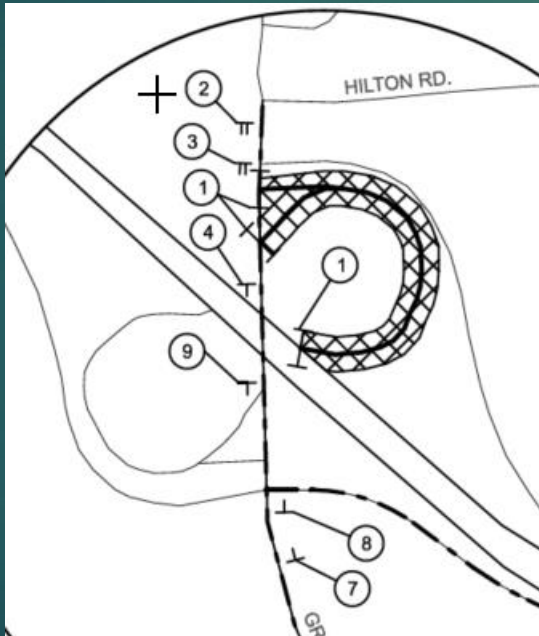

Primary Detour 2

- ▶ During bridge demolition and beam placement:
 - ▶ Night work/potential weekend closure
 - ▶ Hilton Road to Old US-23 south to Grand River Avenue

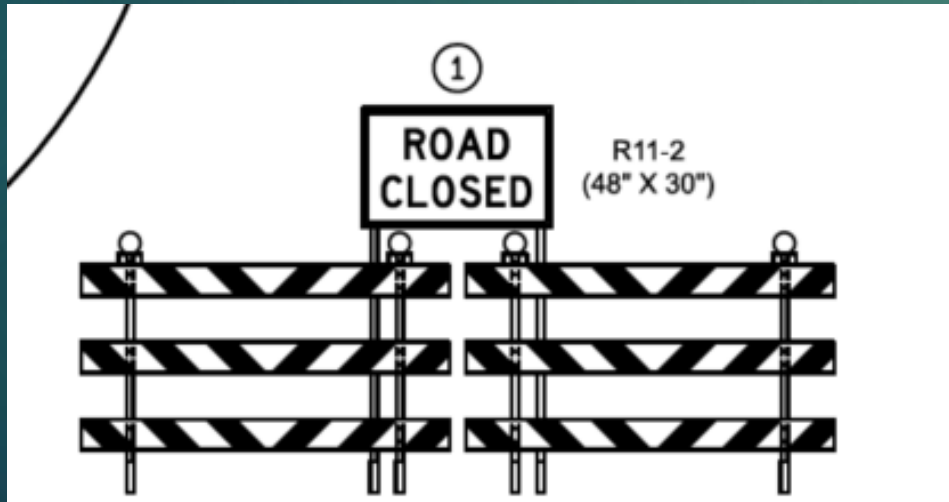
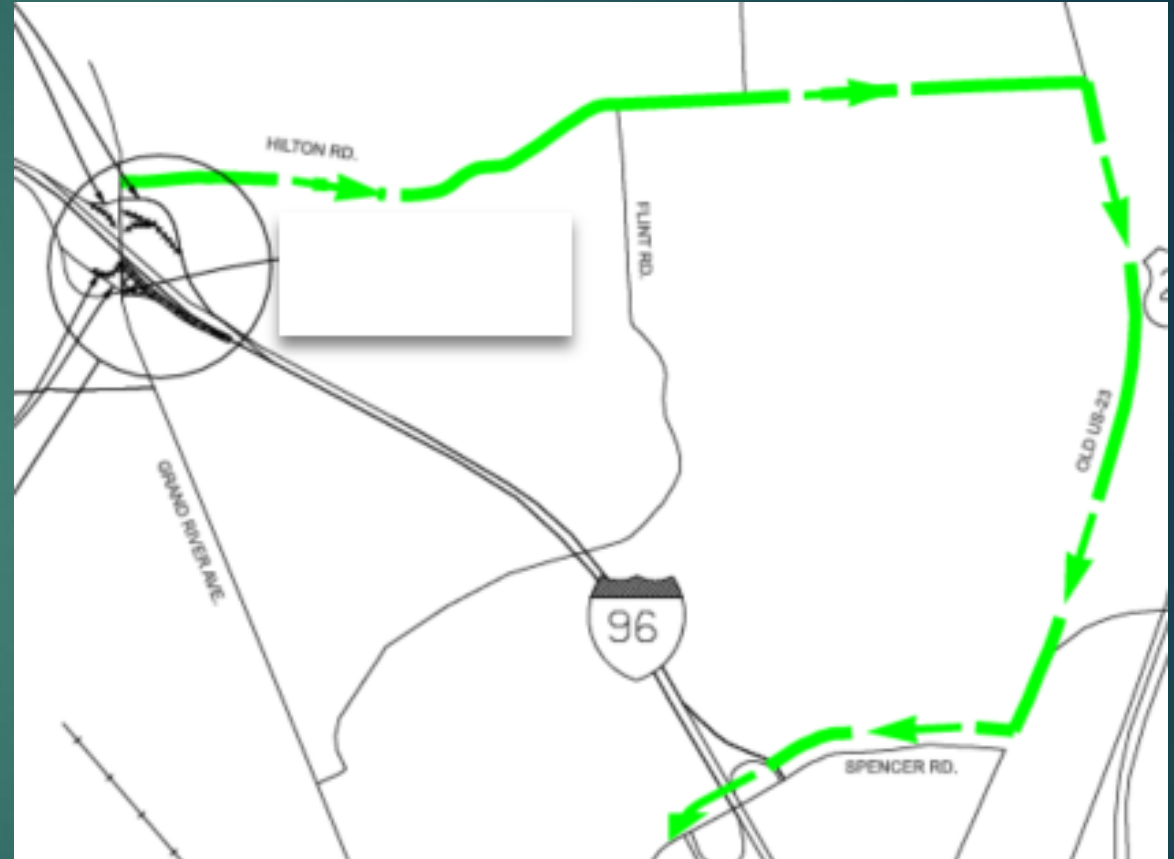



I-96 and Grand River Avenue Stages and Detours

Pre-stage Work (Fall 2024)

- ▶ Build I-96 median crossovers (completed)
 - ▶ Single-lane closures on I-96
- ▶ All traffic back in normal lanes during winter (completed)
- ▶ Tree removal during winter (completed)
- ▶ Completing work required for utility relocation (in process)

Pre-stage

- ▶ Pre-stage work to build median (completed in fall 2024)

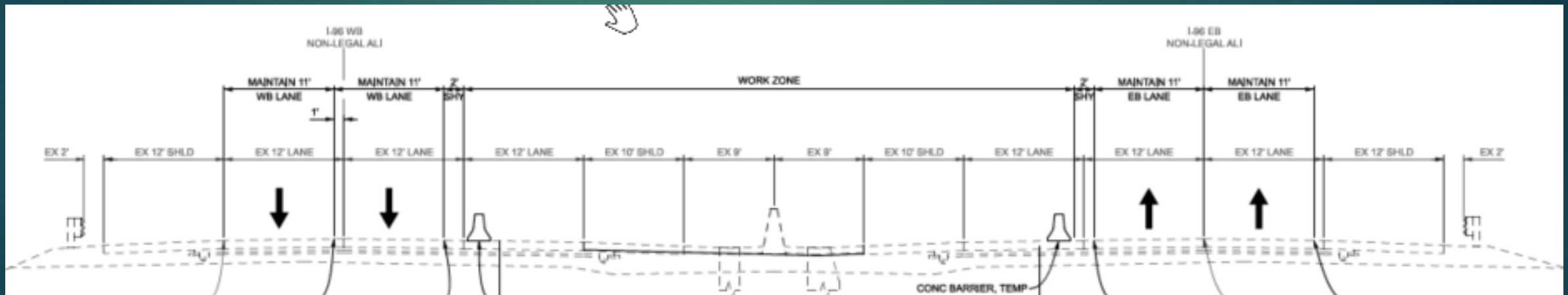

Stage 1 Work (2025)

- ▶ Rebuild westbound I-96
 - ▶ Maintain traffic on eastbound I-96 (two lanes in each direction)
- ▶ Grand River Avenue
 - ▶ Traffic reduced or detoured based on stage
 - ▶ Three major stages
 - ▶ 1A: Beam removal at night
 - ▶ 1B: Loop ramp to westbound I-96 closed
 - ▶ 1C: Grand River Avenue detoured for rebuilding

I-96 Traffic Stage 1

WORK ZONE

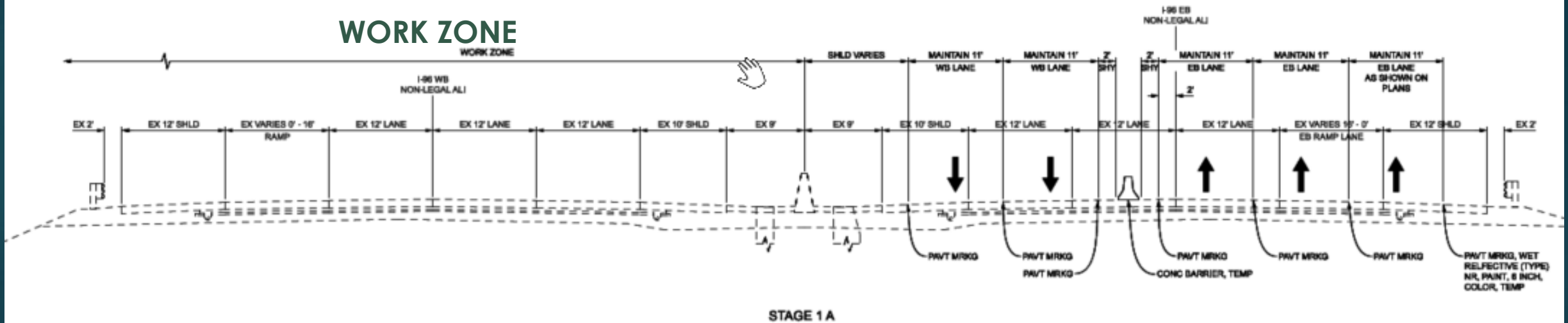

Stage 1A

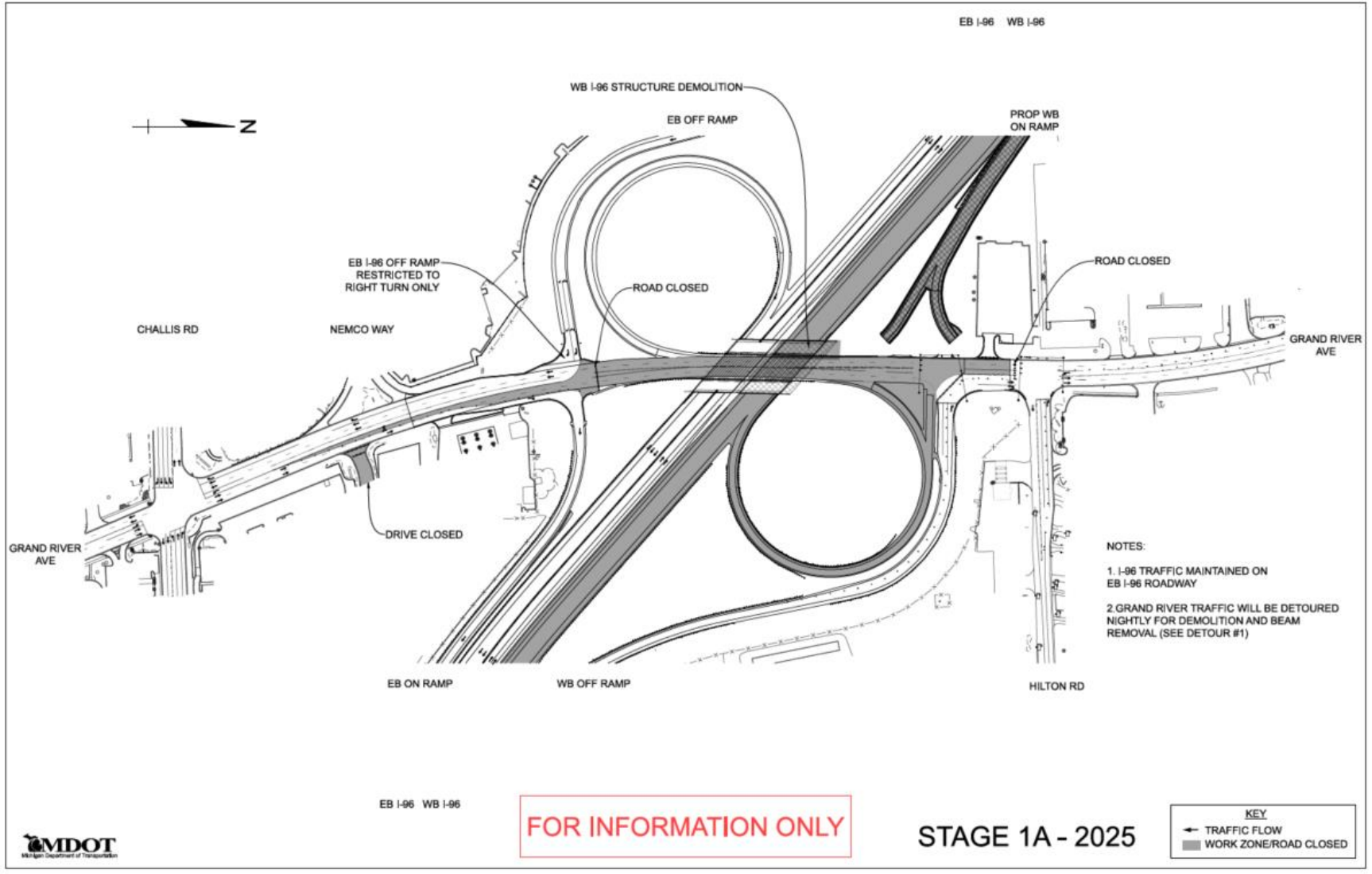

Stage 1A Detours (Night Work)

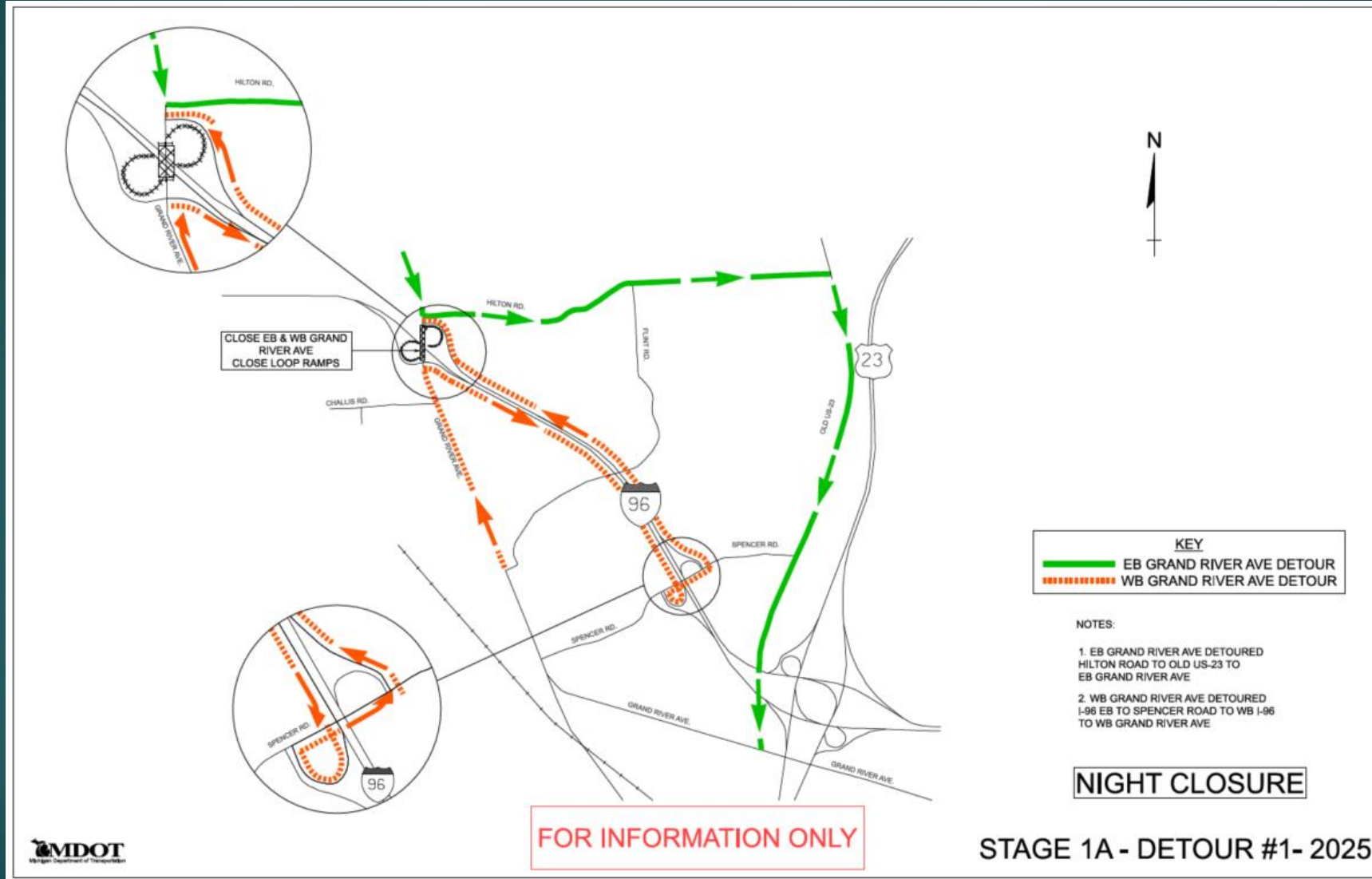

Stage 1B

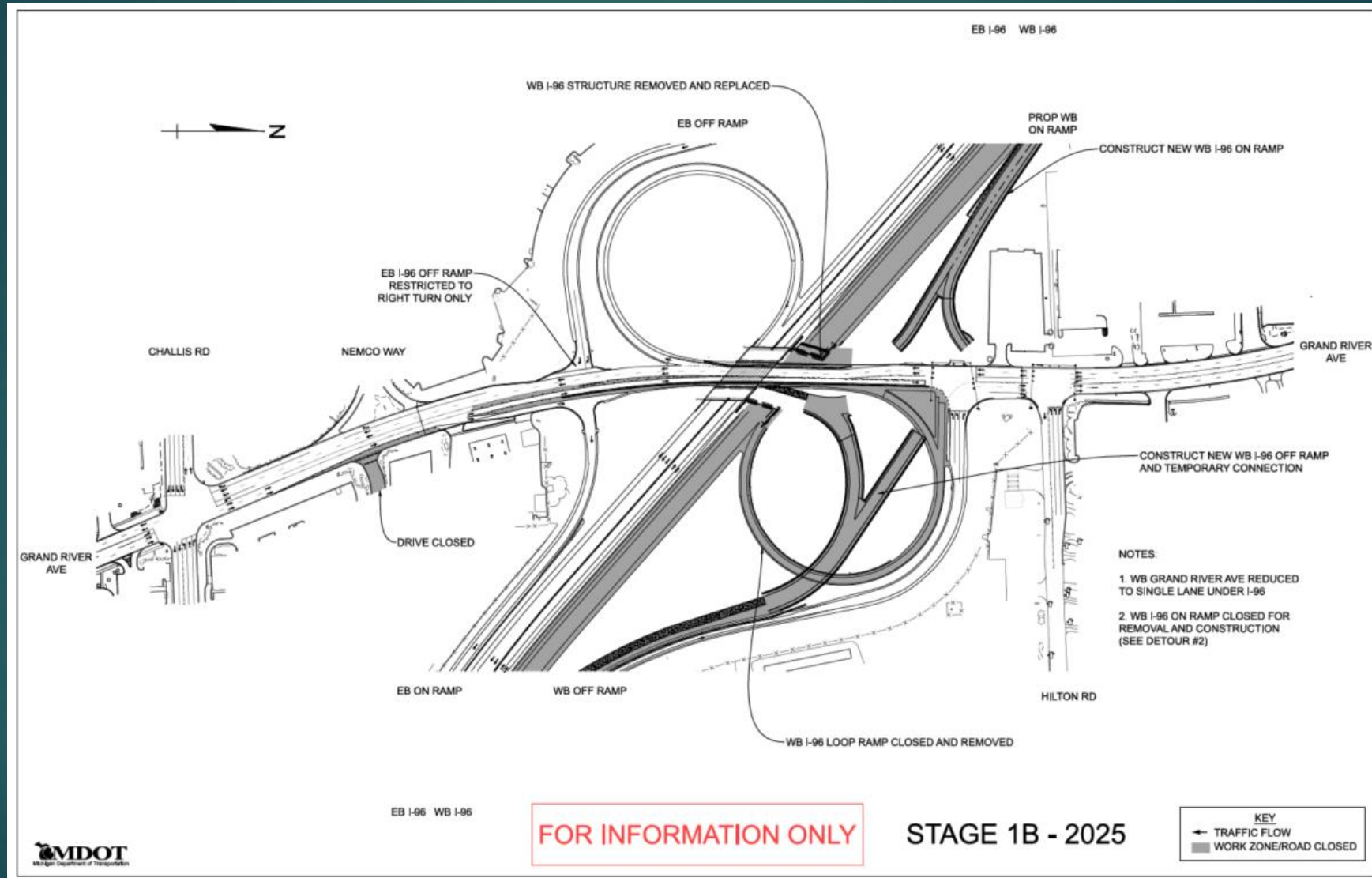

Stage 1B Detour (Spring 2025)

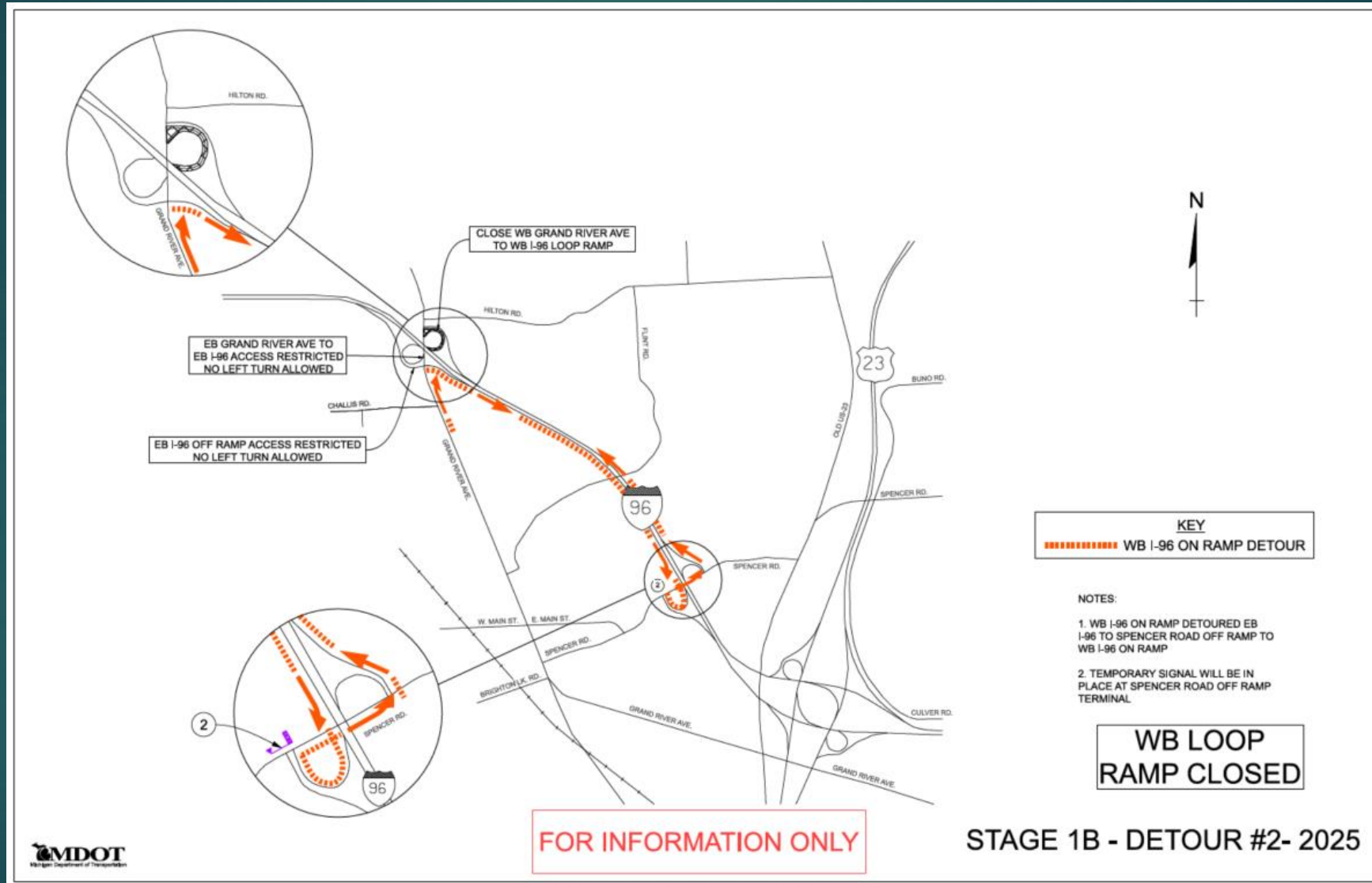

Stage 1C

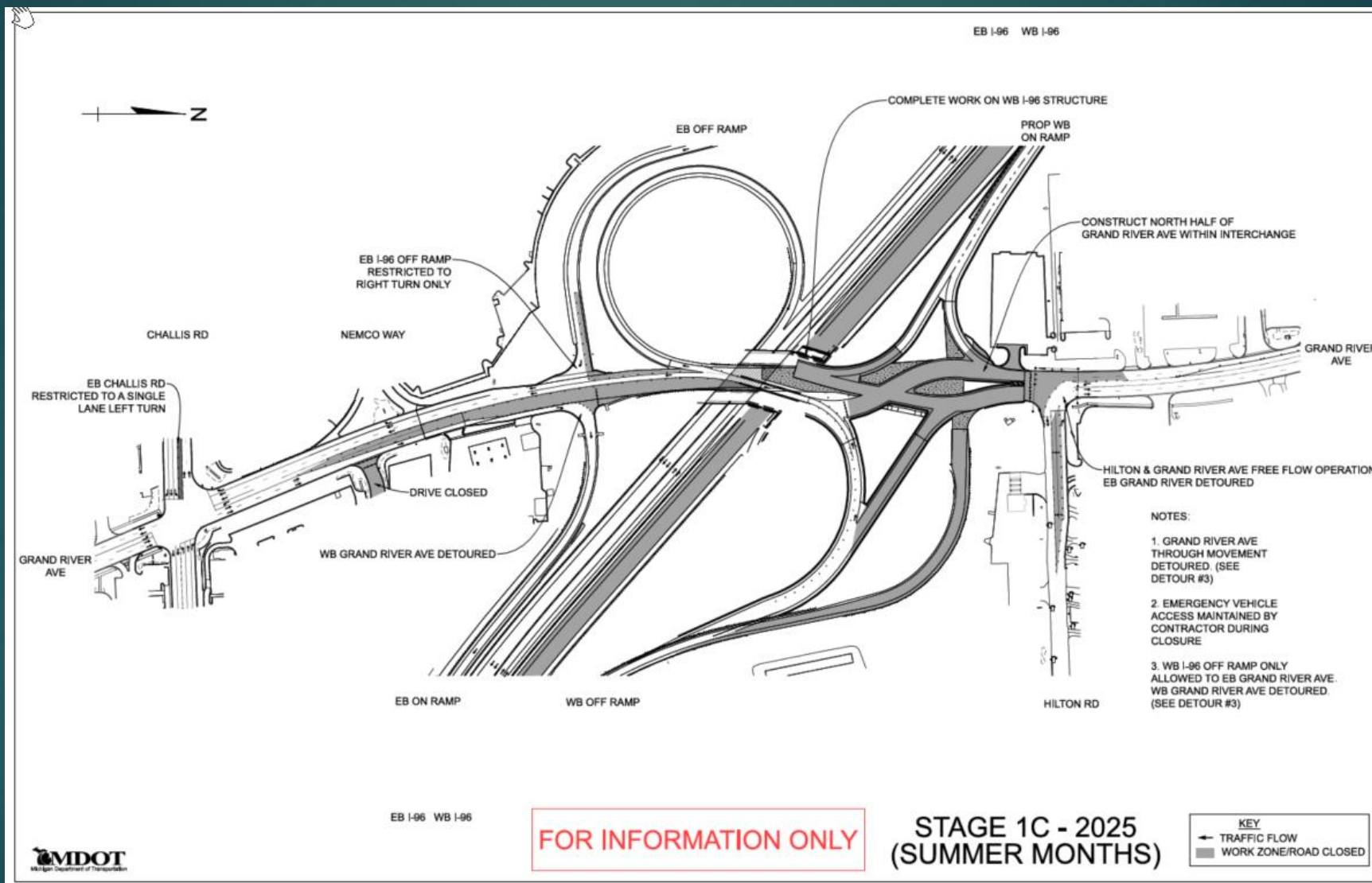

Stage 1C Detours (50 Days)

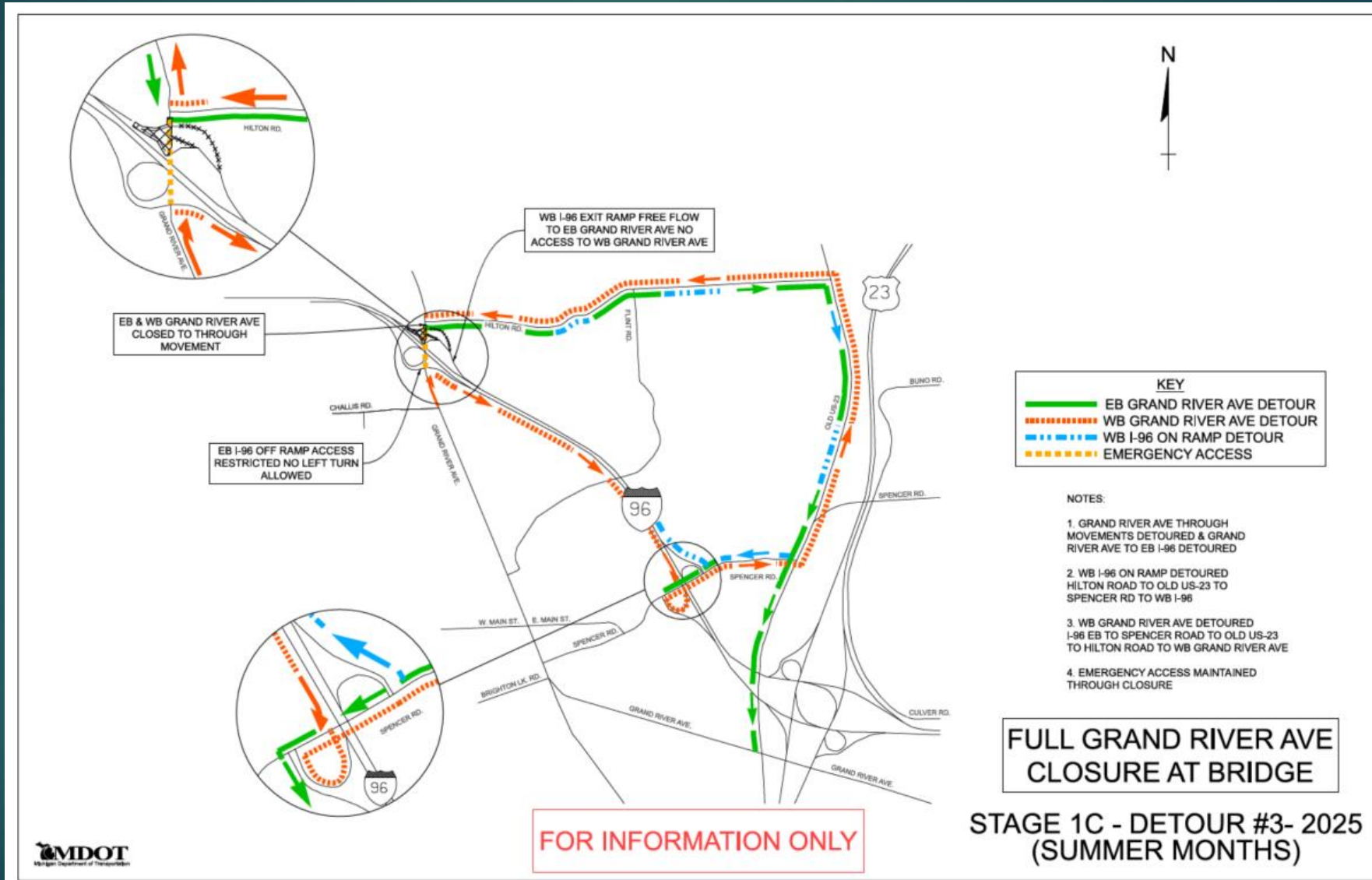

Winter 2025-2026

- ▶ Grand River Avenue and ramps open to traffic with temporary connections.

Winter Shutdown (2025-2026)

